



ANLY CONTROLLER

AVM MONITORING & PROTECTION RELAY



CHARACTERISTIC :

- Protect against :
 - Over Voltage (5% ~ 20%)
 - Under Voltage (5% ~ 20%)
 - Phase Reversal
 - Phase Loss
 - Phase Unbalance ($\pm 20\%$)
- Phase Loss is monitored at start-up and while operating
- Fixed 3 second delay for Phase Unbalance

SPECIFICATION :

Operating voltage	AC(V): 220, 240, 380, 415, 440
Allowable operating voltage range	$\pm 5\% \sim \pm 20\%$ of rated operating voltage
Rated frequency	50 / 60 Hz
Detecting method	Detect 3-phase supply voltage
Reset time	MAX 2S
Contact rating	250VAC 5A (resistive load)
Power consumption	Approx. 2VA
Life	Mechanical: 5,000,000 times Electrical: 100,000 times
Ambient temperature	$-10 \sim +50^{\circ}\text{C}$ (without condensation & freezing)
Ambient humidity	MAX 85%RH (without condensation)
Altitude	MAX 2000m
Weight	Approx. 210g

TYPE SELECTION :

Type	3-Phase 3-Wire		1-Phase 2-Wire	
Standard	AVM-NK	AVM-YK	AVM-NS	AVM-YS
APR-3 Compatible	AVM-NR	AVM-YR	----	----

CONNECTION :

INDICATOR :

AVM-□K

AVM-□R

AVM-□S

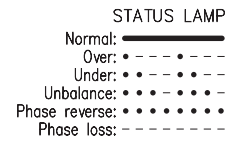
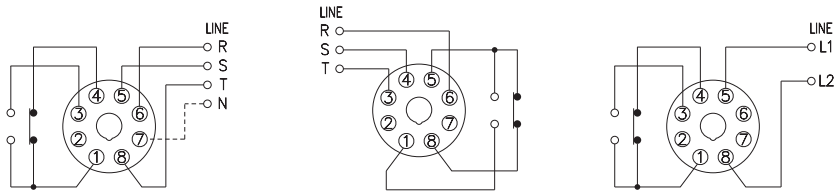

TIMING CHART :

AVM-□K

AVM-□R

AVM-□S

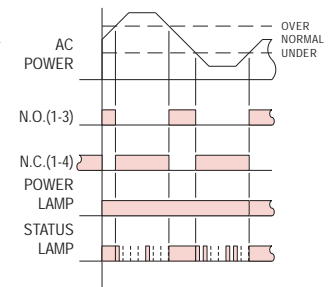
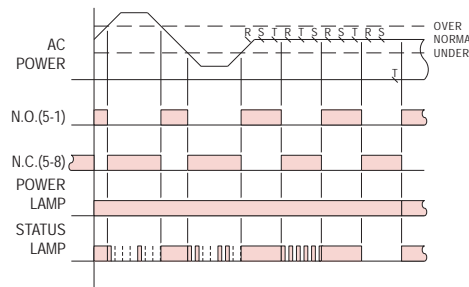
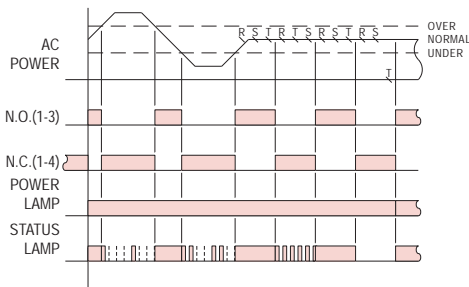

DIMENSIONS : (mm)

N type(Surface Mounting): Using 8PFA Socket

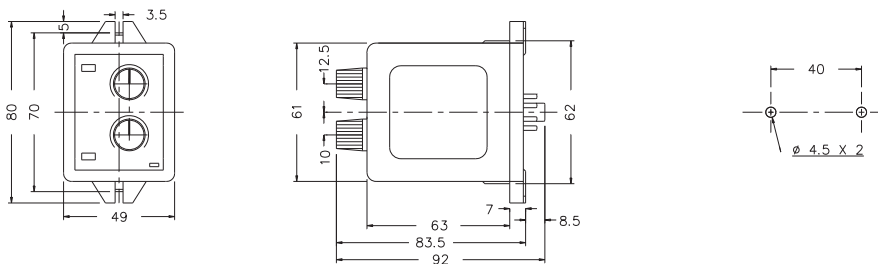

Y type(Flush Mounting): Using US-08 Socket or P3G-08 Socket

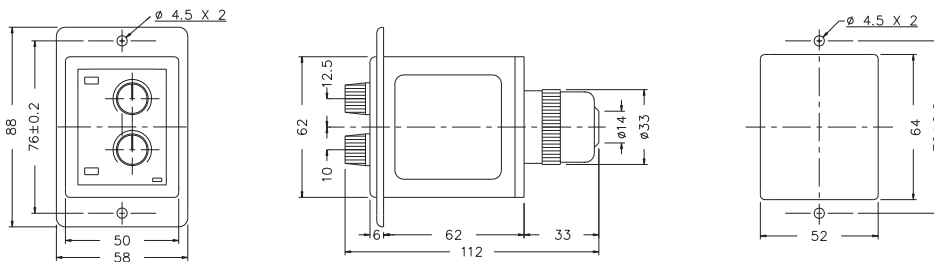

Tolerance:±0.1

ANLY ELECTRONICS CO., LTD.

<http://www.anly.com.tw>

TAIWAN MAIN OFFICE : ANLY ELECTRONICS CO., LTD.

No.19, Lane 202, Fushou St., Xinzhuang Dist., New Taipei City 242, Taiwan
TEL: +886-2-2996-3202 FAX: +886-2-2996-2017

HONG KONG OFFICE : ANLY ELECTRONICS (HK) LTD.

Flat K, 13/F, Edward Mansion, 141 Prince Edward Road W., Kowloon, Hong Kong
TEL: +852-2397-2505 FAX: +852-2397-6080

CHINA OFFICE : ANLY TECHNOLOGY (WUXI) CO., LTD.

2F, Building A, Plot 1, No. 28, Zhanhong Rd., Xinwu Dist., Wuxi, Jiangsu, P.R.China
TEL: +86-510-85304801~3

MALAYSIA OFFICE : JUSTY ELECTRONICS (M) SDN. BHD.

No.1, Jalan 6/89B, Kawasan Perindustrian Trisegi, Batu 3 1/2 Off Jalan Sungei Besi, 57100 Kuala Lumpur, Malaysia
TEL: +60-3-7983-5758 FAX: +60-3-7981-5052

INDONESIA OFFICE : PT. ANLY ELECTRONICS INDONESIA

Jl. Pangeran Jayakarta 117/B9, Jakarta Pusat, 10730 Indonesia
TEL: +62-21-624-8436 FAX: +62-21-626-1228

NO. AVM-W-A